



SINCE 1996

温州赛发电气有限公司
WENZHOU SAIFA ELECTRIC CO.,LTD



CE CB ISO9001 Exe II





ENERGY MANAGEMENT DIN RAIL MOUNTED ENERGY METER



导轨式电能表 Din-rail Type Energy meter

Measuring

Direct measurement up to 100A

Communication

Interface:RS485
Protocol:Modbus-RTU

Energy Metering

Bi-direction energy



DDS7296

DDS7296-1

DDS7296-2

DTS7296-4

DDS7296

DTS7296

Model		DDS7296-1	DDS7296-2	DTS7296-4	DDS7296	DTS7296
Wiring	1P2W	●	●	/	●	/
	3P4W	/	/	●	/	●
Voltage	230V	●	●	/	●	/
	3*230/400V	/	/	●	/	●
Current	Direct	5(40)A	5(63)A	5(100)A	5(100)A	5(100)A
	Via CT	/	/	/	1.5(6)A	1.5(6)A
Measuring	Voltage	●	●	●	●	●
	Current	●	●	●	●	●
	Power	●	●	●	●	●
	Power factor	●	●	●	●	●
	Frequency	●	●	●	●	●
Energy Metering	±kwh	●	●	●	●	●
Width(mm)		18	36	72	72	126
Communication(Modbus-RTU)		●	●	●	●	●
Energy Pulse		●	●	●	●	●
Display Mode		LCD	LCD	LCD	LCD	LCD

★Note: "●": Yes "/":No

Outline Drawing (unit:mm) And Wiring Diagram

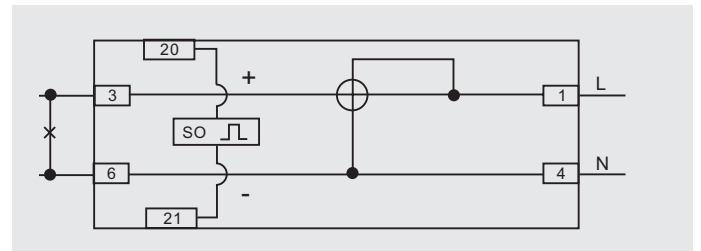
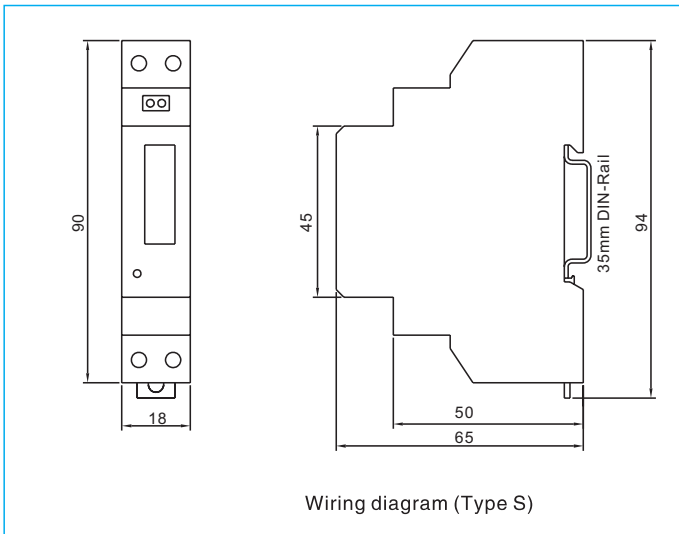

Terminal	Note
1	Inlet phase line
4	Inlet neutral line
3	Outgoing phase line
6	Outgoing neutral line(Inlet from top,outlet from bottom)
20 and 21	Port of pulse output passive

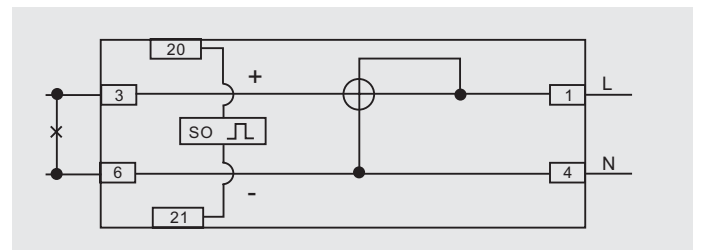
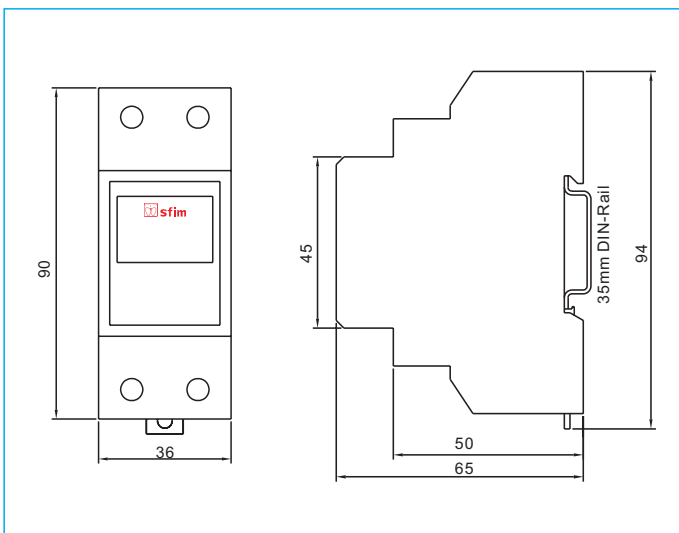

Terminal	Note
1	Inlet phase line
4	Inlet neutral line
3	Outgoing phase line
6	Outgoing neutral line(Inlet from top,outlet from bottom)
20 and 21	Port of pulse output passive

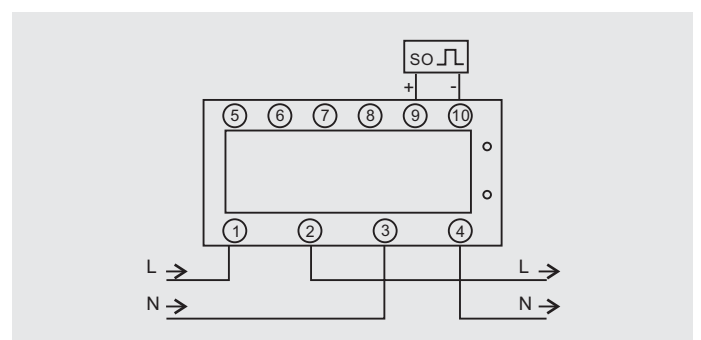
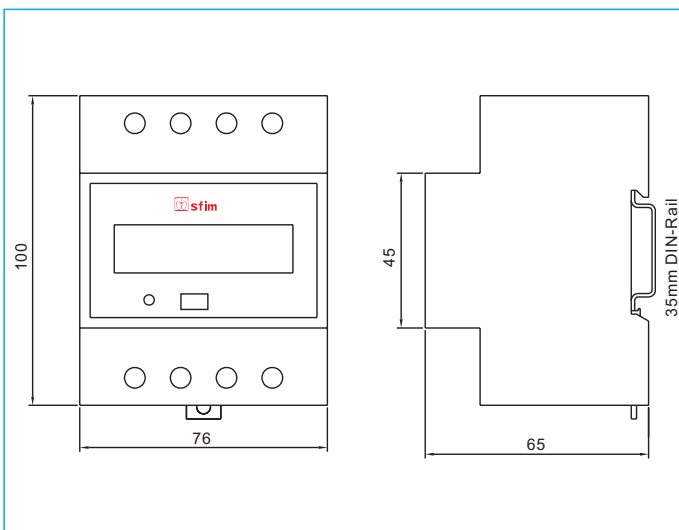

Terminal	Note
1 and 2	IN/OUT
3 and 4	IN/OUT
9 and 10	Passive energy impulse output port

Outline Drawing (unit:mm) And Wiring Diagram

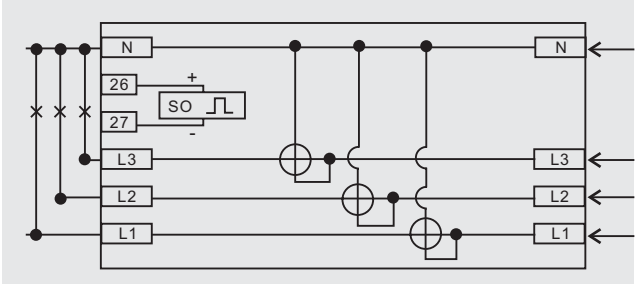
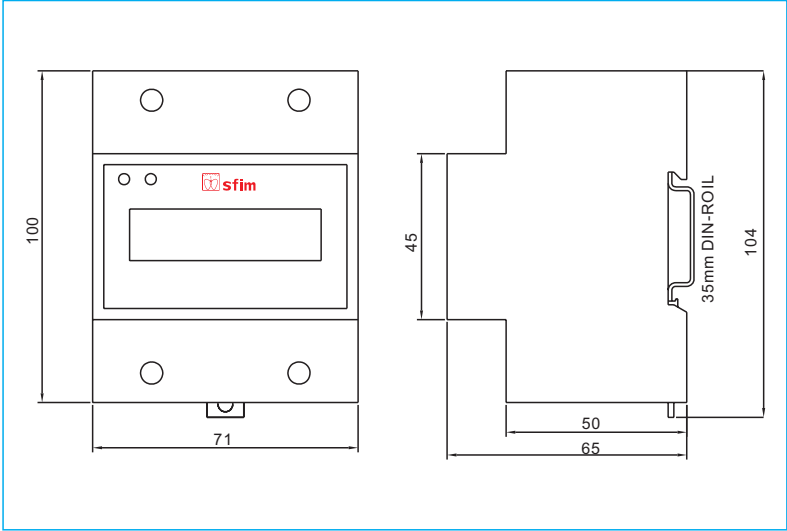

Terminal	Note
L1	L1 phase wire
L2	L2 phase wire
L3	L3 phase wire
N	Neutral wire
26 and 27	Pulse output contact

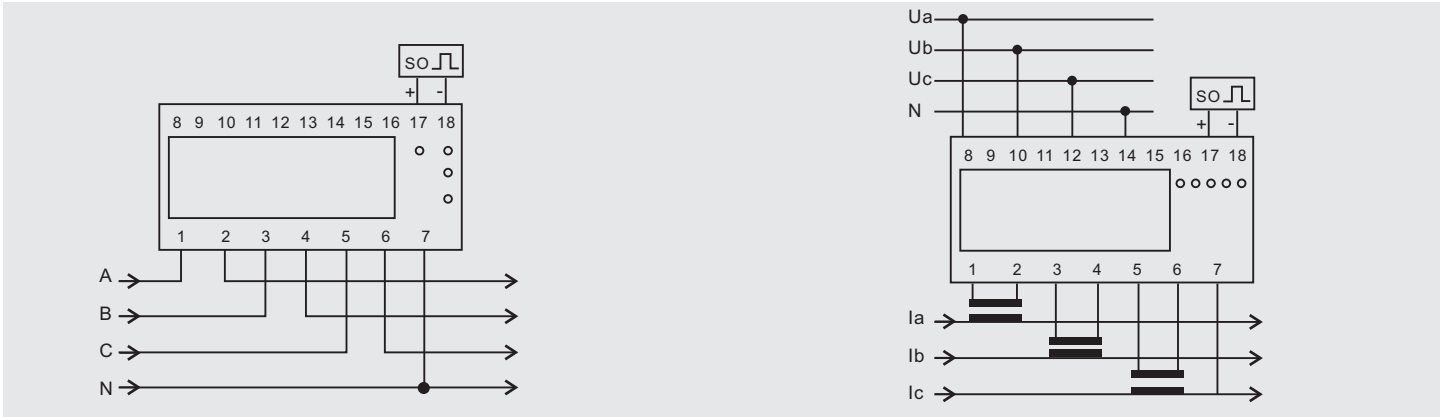
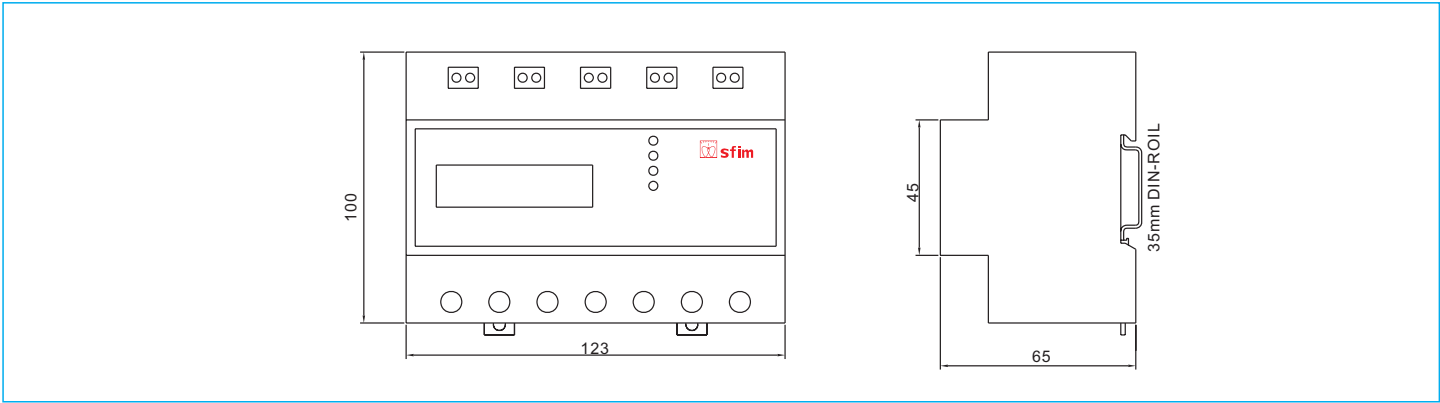

Terminal	Note
1/2	Ia IN/OUT
3/4	Ib IN/OUT
5/6	Ic IN/OUT
7	Neutral wire
17/18	Test pulse output contact

Terminal	Note
1/2	Ia IN/OUT
3/4	Ib IN/OUT
5/6	Ic IN/OUT
8/10/12/14	Neutral wire
7	Neutral wire
17/18	Test pulse output contact